

COMPLEX CONFIGURATORS WITH
CADENAS DATA VIA
CONFIGON

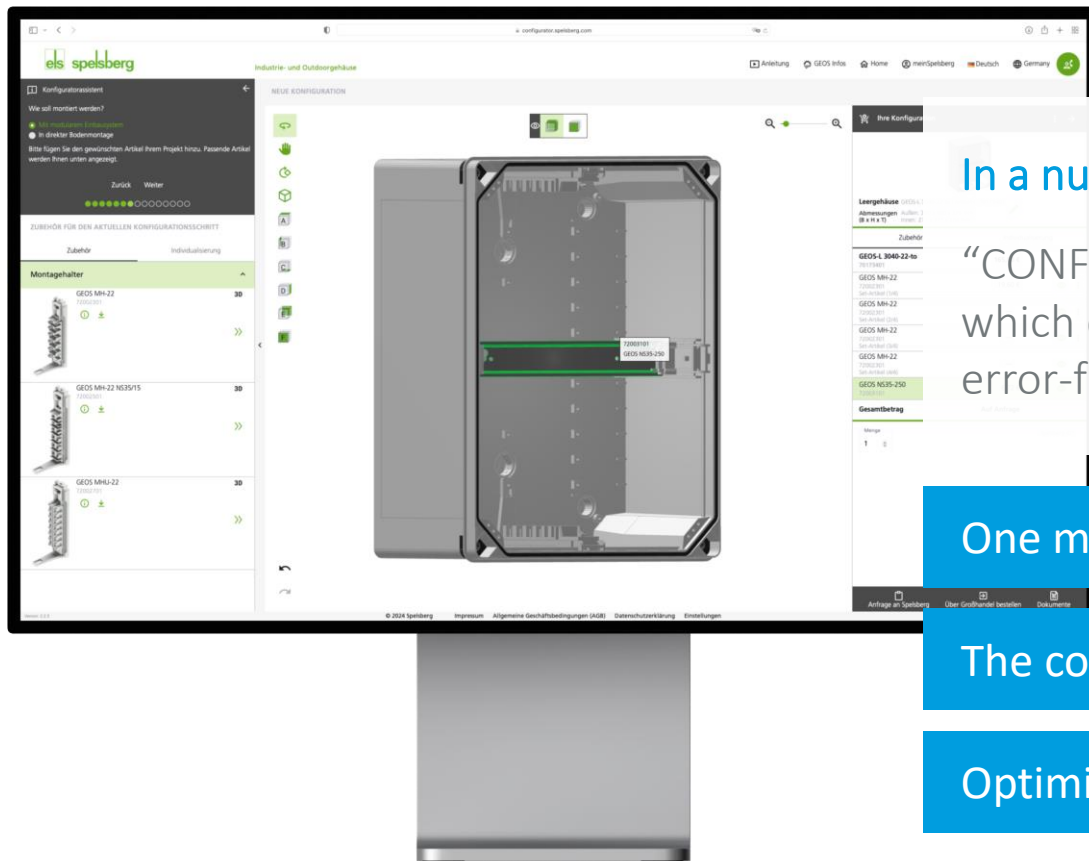

WHAT IS CONFIGON?



In a nutshell:

“CONFIGON is a cross-process, installation-free configurator with which complex technical products can be configured easily and error-free in 2D/3D.”

One modular concept – Various configuration approaches

The configurable product determines the user interface

Optimization of business processes

CONFIGON – COMPLEX PROCESSES MADE EASY

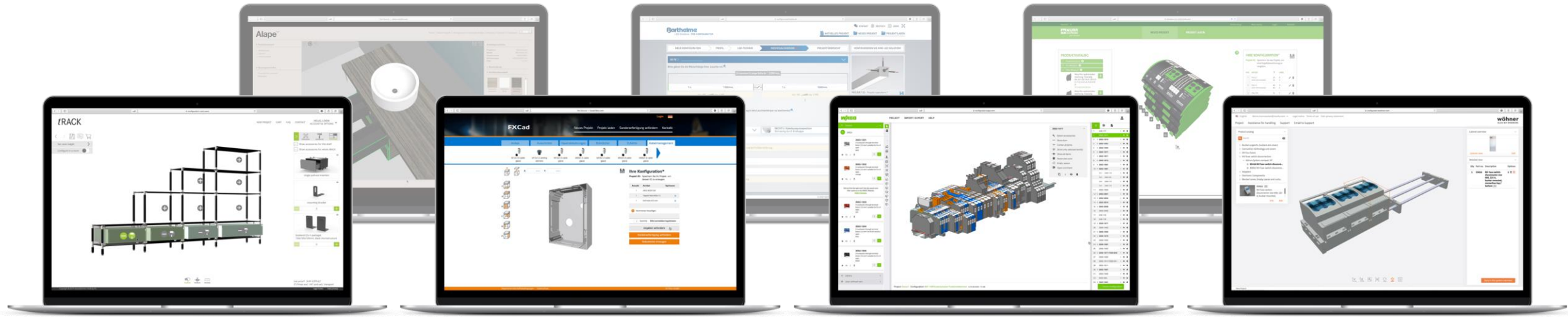

Modules

Customized extensions

Your corporate design:
Customized interface



CONFIGON CORE + 3Dfindit

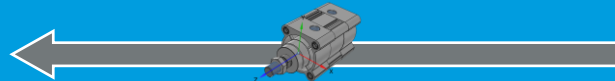

CONFIGON CORE FEATURES

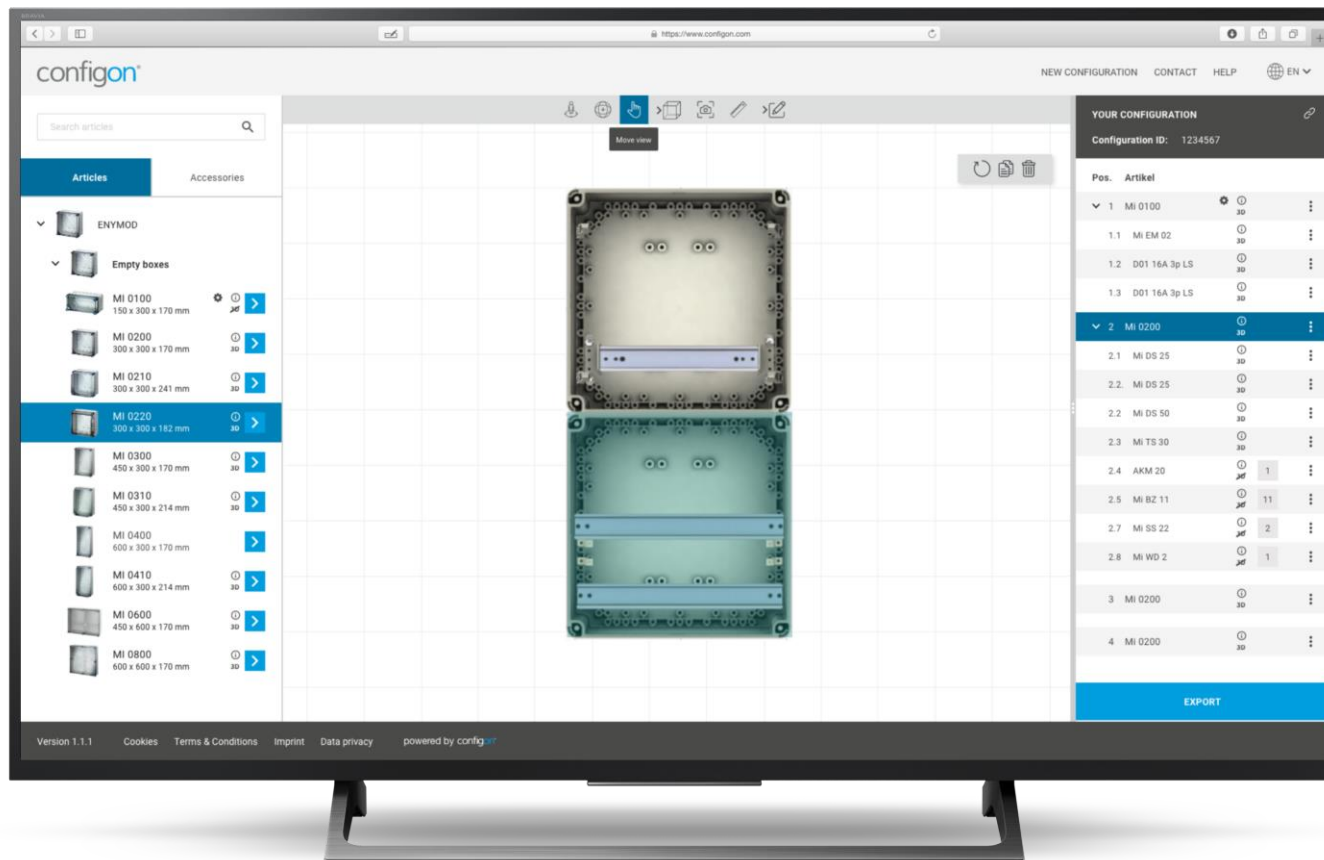

- ✓ White label: Your logo, your colour scheme
- ✓ Build components graphically
- ✓ Maintain data independently in the admin tool without coding
- ✓ Share configurations
- ✓ Export parts lists
- ✓ Transfer data from 3Dfindit
- ✓ Export PDFs
- ✓ CADENAS Multi-CAD export

CONFIGON MODULES

- ✓ Cooperative editing
- ✓ Live support
- ✓ Workflows
- ✓ Process engine
- ✓ Price calculation
(static / dynamic / external)
- ✓ Discount calculation
- ✓ PDF generator
- ✓ User management / permission
concepts
- ✓ Project versioning
- ✓ SSO
- ✓ Rule Engine
- ✓ Renderings
- ✓ PIM interfaces
- ✓ BMEcat
- ✓ ERP interfaces
- ✓ Elbridge
- ✓ Undo / Redo
- ✓ CSG
- ✓ Mailer
- ✓ Analytics
- ✓ Import (CSV, XLSX, XML, JSON...)
- ✓ Export (CSV, XLSX, XML, JSON...)
- ✓ Type key generation
- ✓ 2D projection (2D-DXF)
- ✓ Web shop interface
- ✓ UX testing
- ✓ SLA
- ✓ White label & custom design

LIVE DEMO

CONFIGON IN ACTION



CONFIGON IN ACTION

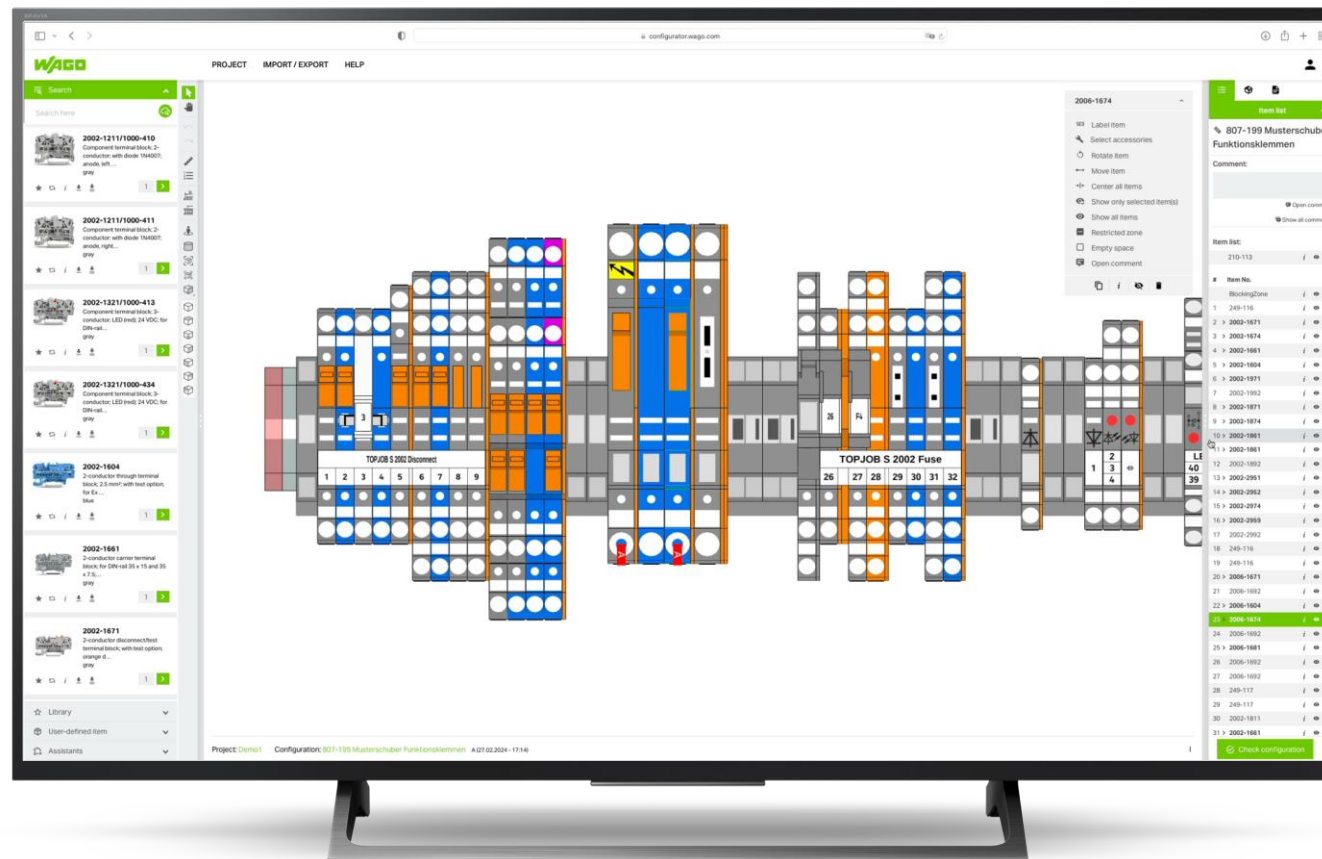

Search here

- 2002-1211/1000-410**
Component terminal block; 2-conductor; with diode 1N4007; anode, left ... gray
- 2002-1211/1000-411**
Component terminal block; 2-conductor; with diode 1N4007; anode, right... gray
- 2002-1321/1000-413**
Component terminal block; 3-conductor; LED (red); 24 VDC; for DIN-rail... gray
- 2002-1321/1000-434**
Component terminal block; 3-conductor; LED (red); 24 VDC; for DIN-rail... gray
- 2002-1604**
2-conductor through terminal block; 2.5 mm²; with test option; for Ex ... blue
- 2002-1661**
2-conductor carrier terminal block; for DIN-rail 35 x 15 and 35 x 7.5;... gray
- 2002-1671**
2-conductor disconnect/test terminal block; with test option; orange d... gray

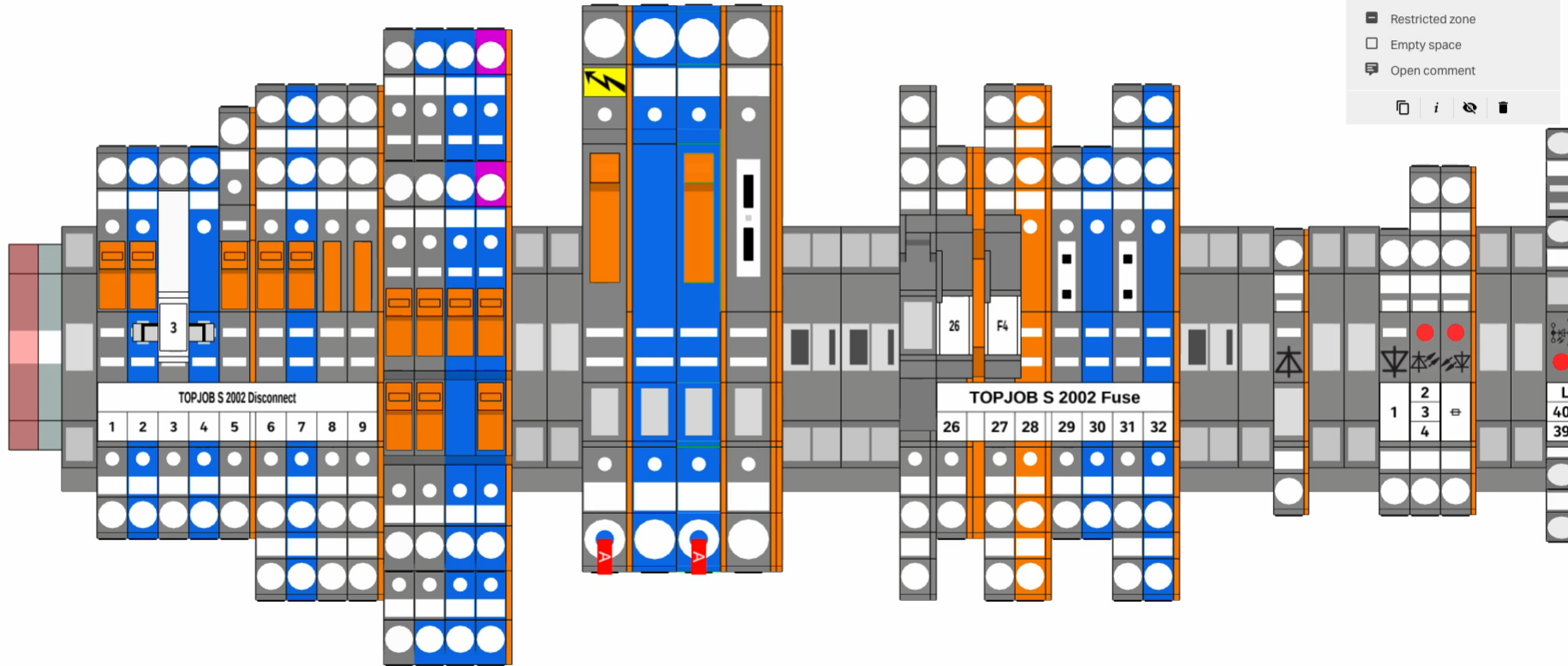

- 2006-1674**
- Label Item
 - Select accessories
 - Rotate Item
 - Move Item
 - Center all Items
 - Show only selected item(s)
 - Show all Items
 - Restricted zone
 - Empty space
 - Open comment

Item list

807-199 Musterschuber Funktionsklemmen

Comment:

Item list:

| # | Item No. | BlockingZone |
|----|-------------|--------------|
| 1 | 249-116 | |
| 2 | > 2002-1671 | |
| 3 | > 2002-1674 | |
| 4 | > 2002-1661 | |
| 5 | > 2002-1604 | |
| 6 | > 2002-1971 | |
| 7 | 2002-1992 | |
| 8 | > 2002-1871 | |
| 9 | > 2002-1874 | |
| 10 | > 2002-1861 | |
| 11 | > 2002-1861 | |
| 12 | 2002-1892 | |
| 13 | > 2002-2951 | |
| 14 | > 2002-2952 | |
| 15 | > 2002-2974 | |
| 16 | > 2002-2959 | |
| 17 | 2002-2992 | |
| 18 | 249-116 | |
| 19 | 249-116 | |
| 20 | > 2006-1671 | |
| 21 | 2006-1692 | |
| 22 | > 2006-1604 | |
| 23 | > 2006-1674 | |
| 24 | 2006-1692 | |
| 25 | > 2006-1681 | |
| 26 | 2006-1692 | |
| 27 | 2006-1692 | |
| 28 | 249-117 | |
| 29 | 249-117 | |
| 30 | 2002-1811 | |
| 31 | > 2002-1661 | |

CONFIGON IN ACTION

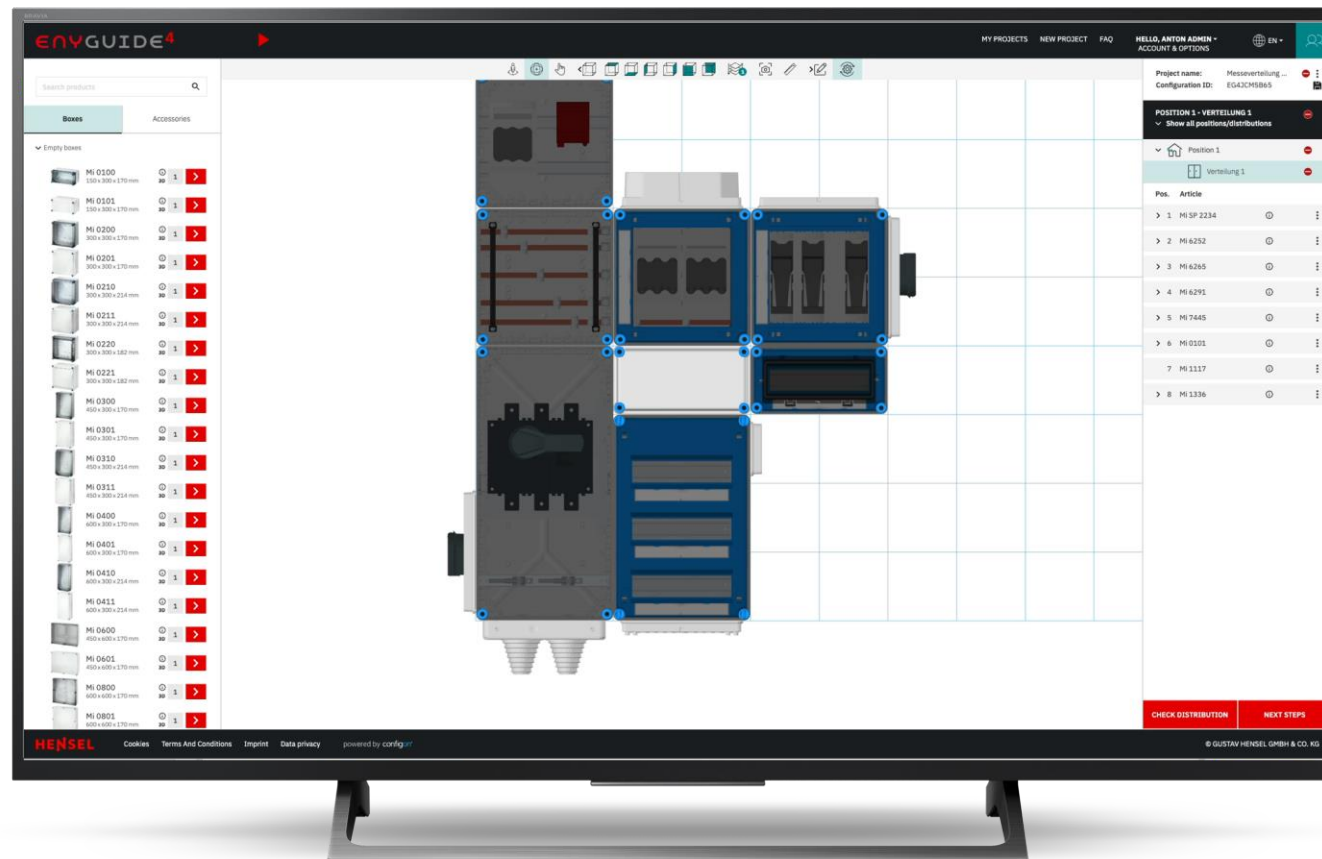

Search products

Boxes Accessories

Empty boxes

-  **Mi 0100**
150 x 300 x 170 mm 3D 1 >
-  **Mi 0101**
150 x 300 x 170 mm 3D 1 >
-  **Mi 0200**
300 x 300 x 170 mm 3D 1 >
-  **Mi 0201**
300 x 300 x 170 mm 3D 1 >
-  **Mi 0210**
300 x 300 x 214 mm 3D 1 >
-  **Mi 0211**
300 x 300 x 214 mm 3D 1 >
-  **Mi 0220**
300 x 300 x 182 mm 3D 1 >
-  **Mi 0221**
300 x 300 x 182 mm 3D 1 >
-  **Mi 0300**
450 x 300 x 170 mm 3D 1 >
-  **Mi 0301**
450 x 300 x 170 mm 3D 1 >
-  **Mi 0310**
450 x 300 x 214 mm 3D 1 >
-  **Mi 0311**
450 x 300 x 214 mm 3D 1 >
-  **Mi 0400**
600 x 300 x 170 mm 3D 1 >
-  **Mi 0401**
600 x 300 x 170 mm 3D 1 >
-  **Mi 0410**
600 x 300 x 214 mm 3D 1 >
-  **Mi 0411**
600 x 300 x 214 mm 3D 1 >
-  **Mi 0600**
450 x 600 x 170 mm 3D 1 >
-  **Mi 0601**
450 x 600 x 170 mm 3D 1 >
-  **Mi 0800**
600 x 600 x 170 mm 3D 1 >
-  **Mi 0801**
600 x 600 x 170 mm 3D 1 >

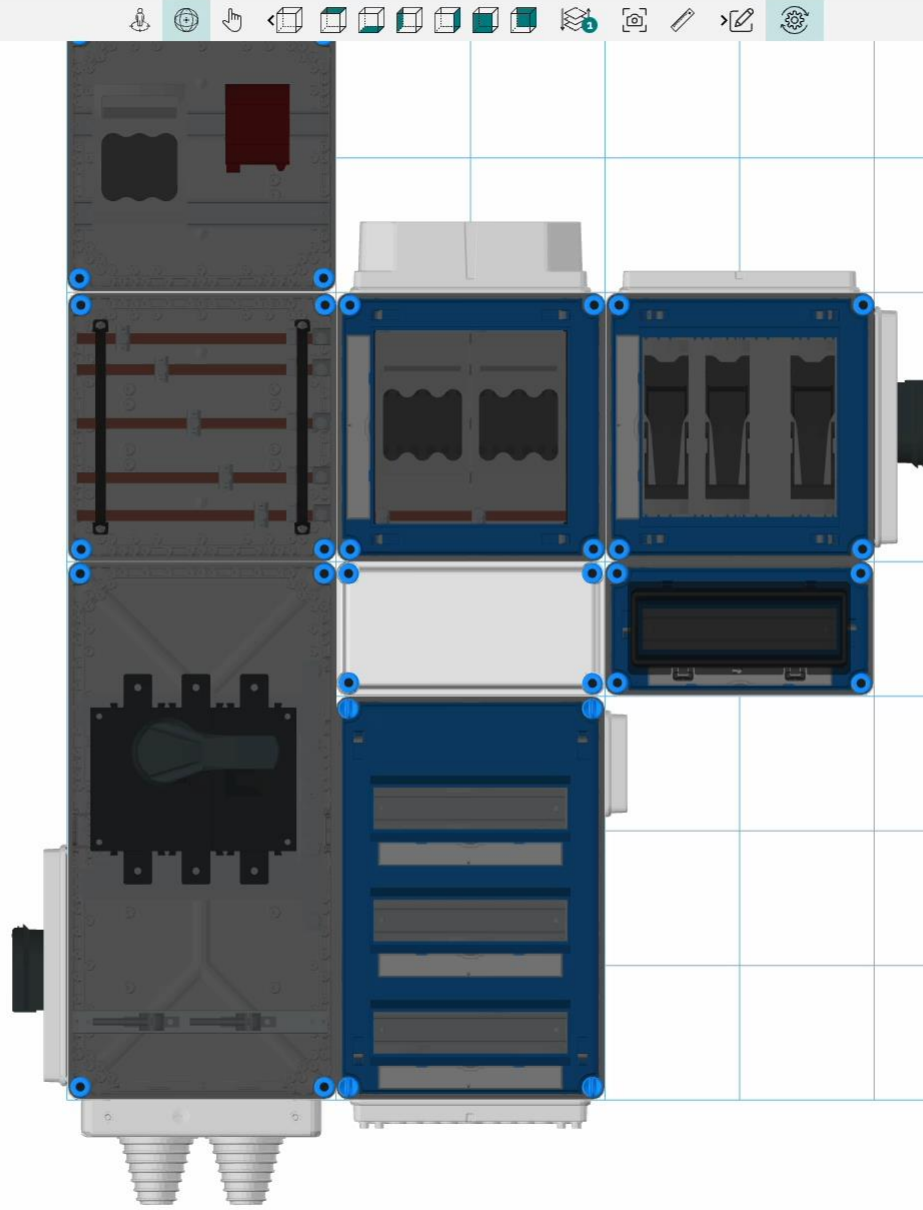

Project name: Messeverteilung ...
Configuration ID: EG4JCM5B65

POSITION 1 - VERTEILUNG 1
Show all positions/distributions

- Position 1
- Verteilung 1

| Pos. | Article | | |
|------|------------|---|---|
| > 1 | Mi SP 2234 | ⊙ | ⋮ |
| > 2 | Mi 6252 | ⊙ | ⋮ |
| > 3 | Mi 6265 | ⊙ | ⋮ |
| > 4 | Mi 6291 | ⊙ | ⋮ |
| > 5 | Mi 7445 | ⊙ | ⋮ |
| > 6 | Mi 0101 | ⊙ | ⋮ |
| 7 | Mi 1117 | ⊙ | ⋮ |
| > 8 | Mi 1336 | ⊙ | ⋮ |

CHECK DISTRIBUTION NEXT STEPS

CONFIGON IN ACTION

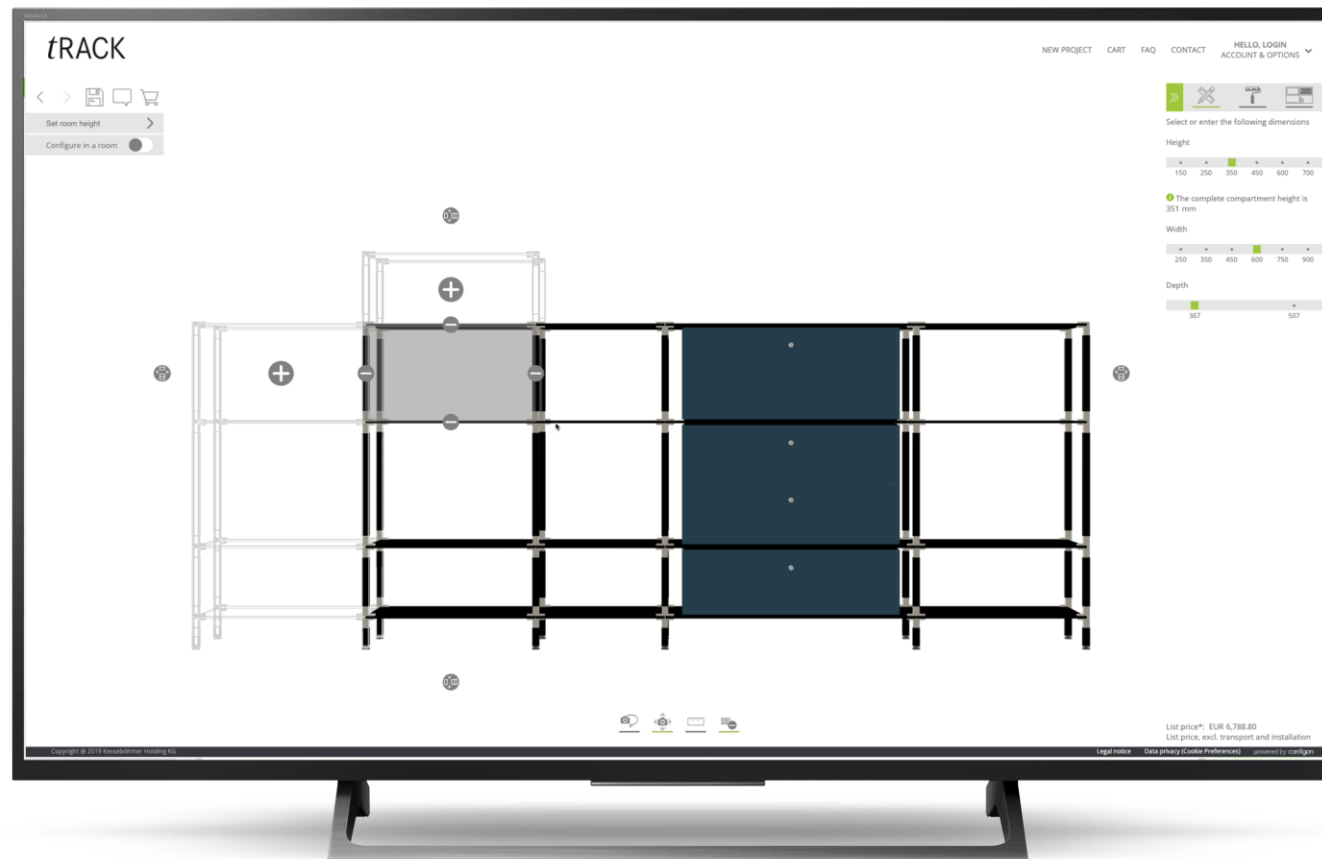



Select or enter the following dimensions

Height



The complete compartment height is 351 mm

Width

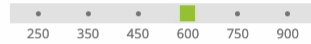

Depth

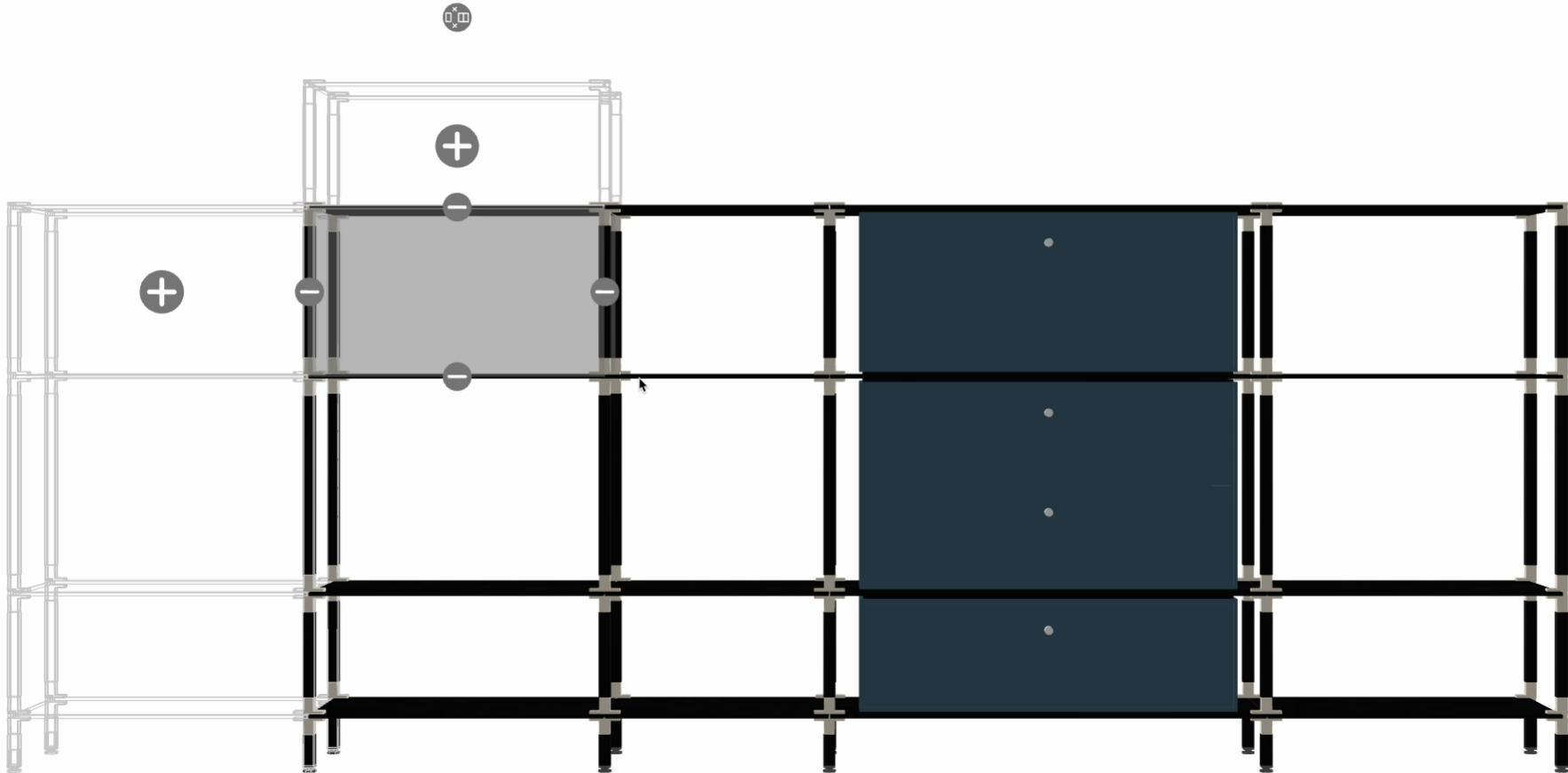

List price*: EUR 6,788.80
List price, excl. transport and installation

COMPLEX PROCESSES MADE EASY

