

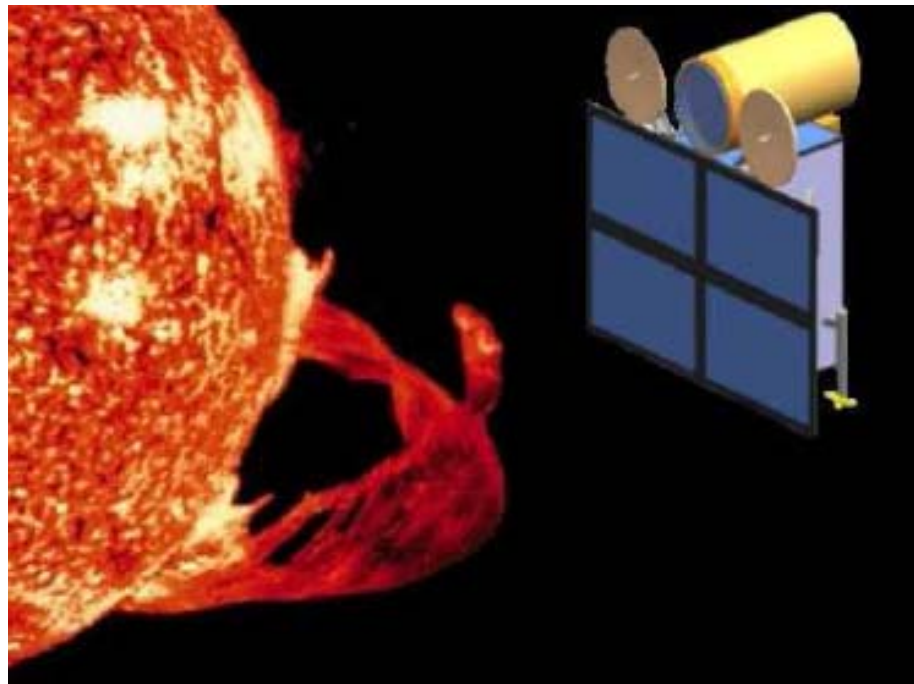

→ ADAHELI

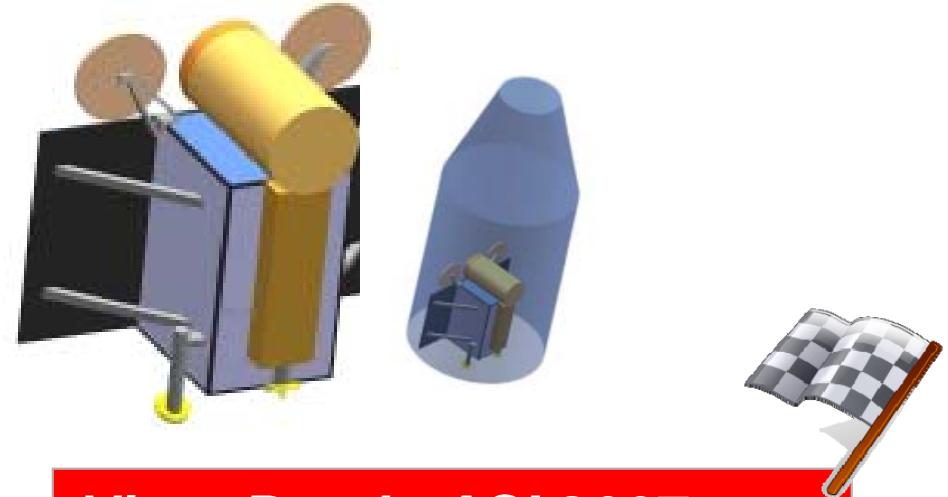

**Phase A study for a satellite with a Solar Telescope on board**



**Vinto Bando ASI 2007 per "Proposte di Piccole Missioni"**



→ ADAHELI

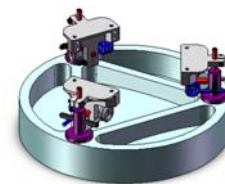
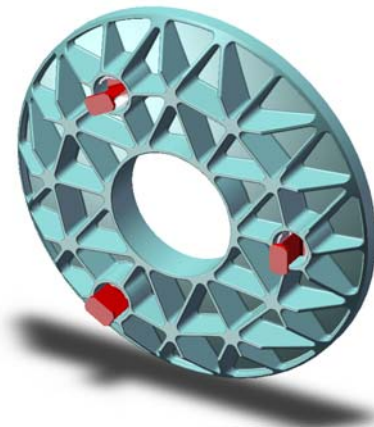
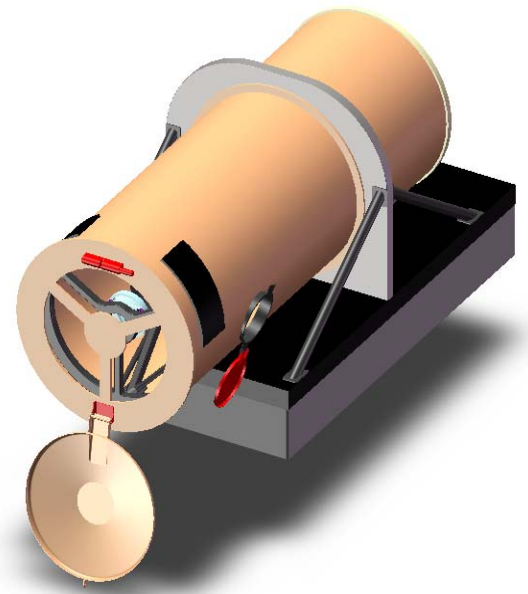
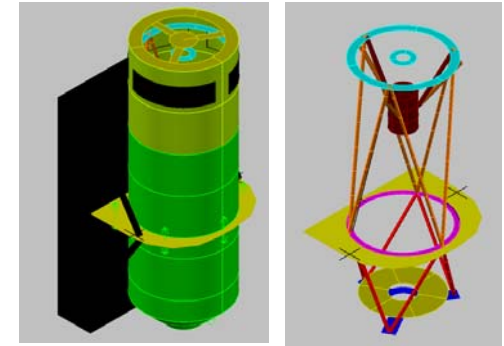
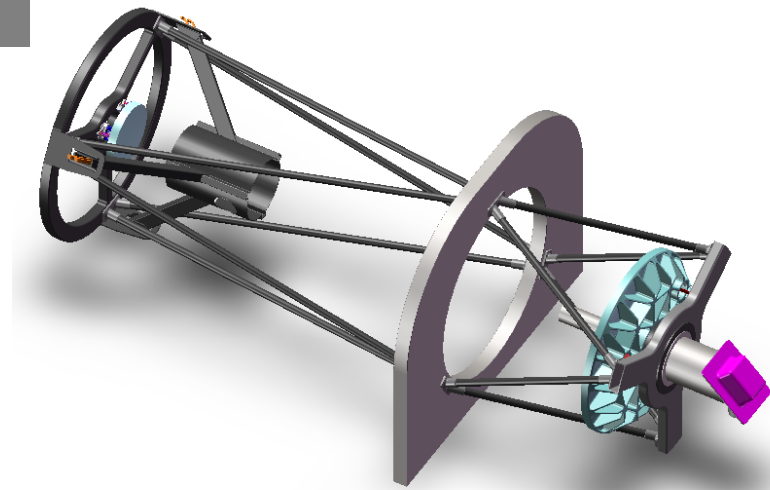

Contour (Analysis system)  
Displacement (Mag)

1.686E+01
1.499E+01
1.312E+01
1.125E+01
9.384E+00
7.514E+00
5.644E+00
3.774E+00
1.905E+00
-3.487E-02
No result
Max = 1.686E+01
Min = 3.487E-02

